

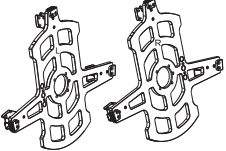



Thank you for purchasing the Autel Calibration Bar-R&T Mounts, which provide users with a 2-in-1 solution that is compatible with both rim clamps and tire clamps. This Quick Reference Guide instructs you on how to install and use the product. Please read this guide carefully before use.

Packing List

	1 pair		8 pcs		1 pc		1 pc
Calibration Bar-R&T Mounts		Socket Head Cap Screw (M5 x 20)		Allen Key (4 mm)		Quick Reference Guide (this document)	

Installing the Calibration Bar-R&T Mounts



NOTE:

1. The Calibration Bar-Rim & Tire Clamp Mounts, namely the Calibration Bar-R&T Mounts, are to be used with the base and shaft of the Autel Calibration Bar (AUTEL-CSC0500/10). Be sure that you already have the Autel Calibration Bar prior to purchasing this product.
2. Before beginning the installation, remove the Calibration Bar-R&T Mounts and tools from the package.

1

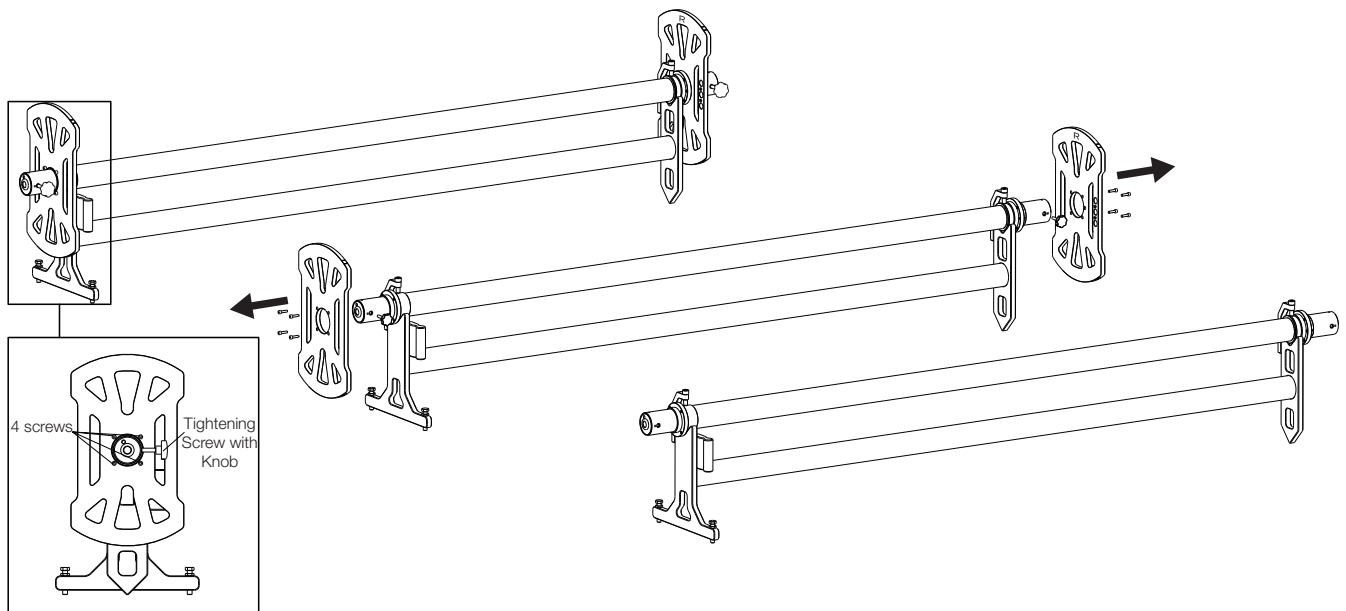

Place your assembled Autel Calibration Bar (AUTEL-CSC0500/10) on a flat surface with sufficient room. Rotate the two tightening screws counterclockwise to remove them from the shaft. Unscrew the eight screws to remove the two calibration bar-rim clamp mounts from the shaft by using the 4 mm Allen key. Store all of them away.

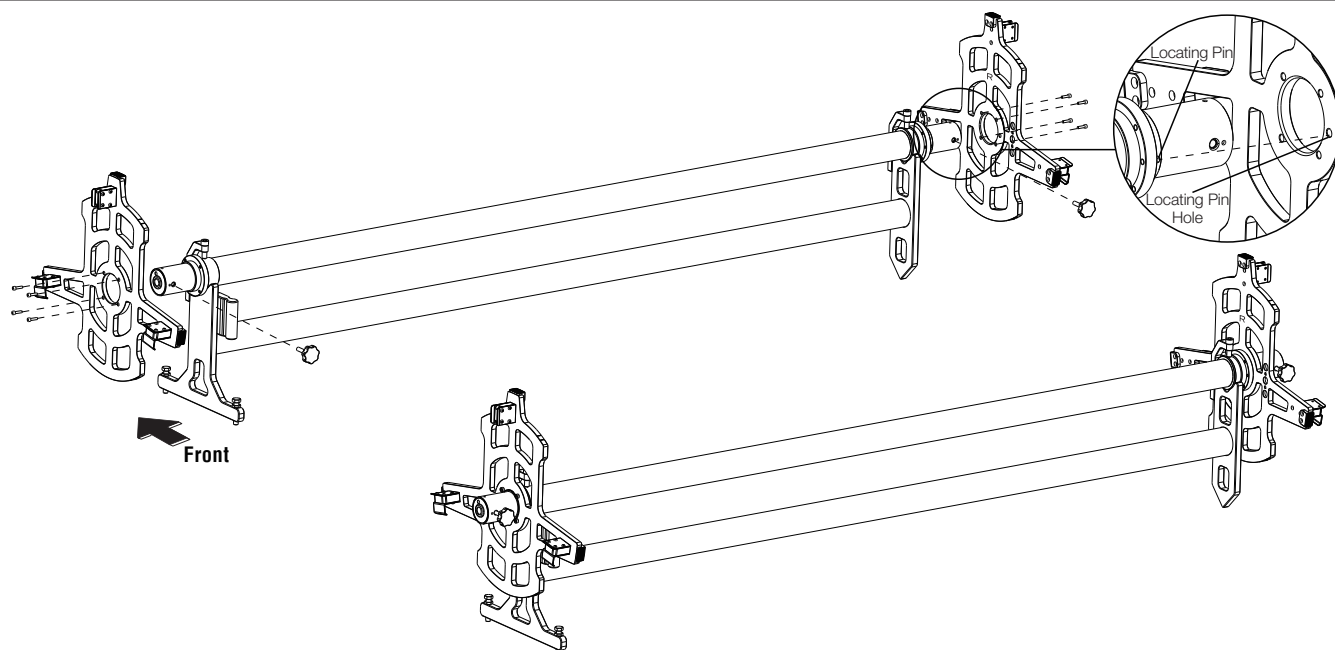

Face the front of the base. Install the right Calibration Bar-R&T Mount (labeled R on its back) on the right end of the shaft with the locating pin inserted into the corresponding hole, thus making the four holes on the right mount align with the four holes on the shaft.

Use the 4 mm Allen key to install the four socket head cap screws (M5 x 20) into the four holes. Reinstall the tightening screw. The right mount is now installed.

Install the left Calibration Bar-R&T Mount (labeled L on its back) on the left end of the shaft in the same manner.

Attaching the Tire Clamps

After the Calibration Bar-R&T Mounts are correctly installed, you can begin to attach the tire clamps to them.



NOTE:

1. Before installing the tire clamps on the calibration bar mounts, make sure that you already have the Autel Tire Clamp Kit (AUTEL-CSC0500/17).
2. The left tire clamp, labeled AUTEL-CSC0500/17/LF or AUTEL-CSC0500/17/LR, should be installed on the left calibration bar mount, and the right tire clamp, labeled AUTEL-CSC0500/17/RF or AUTEL-CSC0500/17/RR, should be installed on the right calibration bar mount.

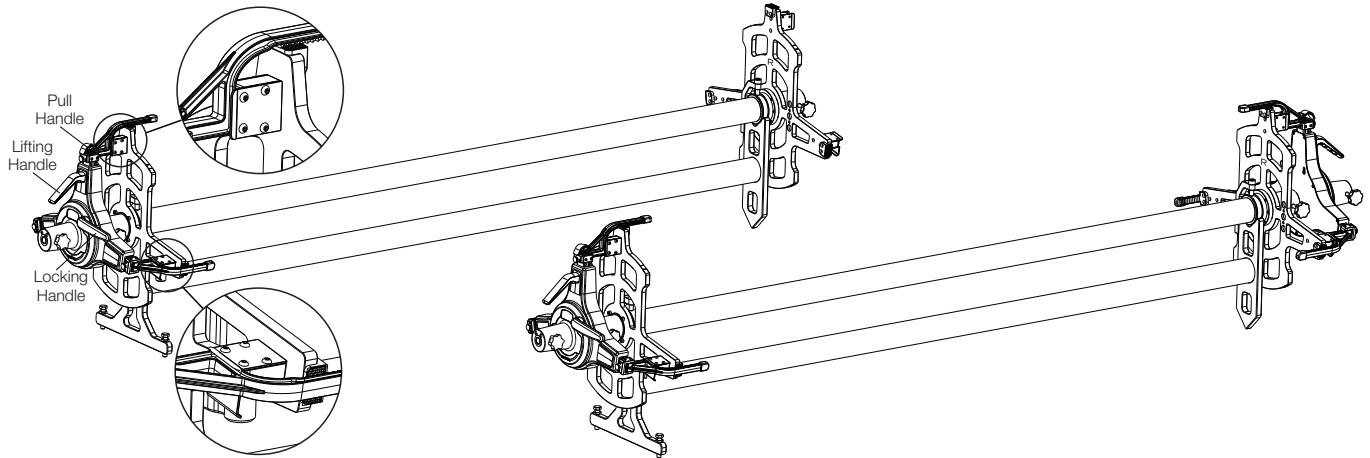

Hold the left tire clamp and face the left calibration bar mount. Grasp the lifting handle of the tire clamp with one hand and raise the pull handle with the other hand to install it on the calibration bar mount. Ensure that the horizontal parts on the three pawls are inserted into the three limiting grooves on the mount. When the tire clamp is placed in the proper position, release the pull handle and lock the locking handle clockwise to secure the tire clamp. The left tire clamp is now installed.

Hold the right tire clamp and face the right calibration bar mount. Install the right tire clamp in the same fashion.

Attaching the Rim Clamps

After the Calibration Bar-R&T Mounts are correctly installed, you can begin to attach the rim clamps to them.



NOTE:

1. Before installing the rim clamps on the calibration bar mounts, make sure that you already have the Autel rim clamps (AUTEL-CSC0500/19).
2. The left rim clamp, labeled AUTEL-CSC0500/19/LF or AUTEL-CSC0500/19/LR, should be installed on the left calibration bar mount, and the right rim clamp, labeled AUTEL-CSC0500/19/RF or AUTEL-CSC0500/19/RR, should be installed on the right calibration bar mount.

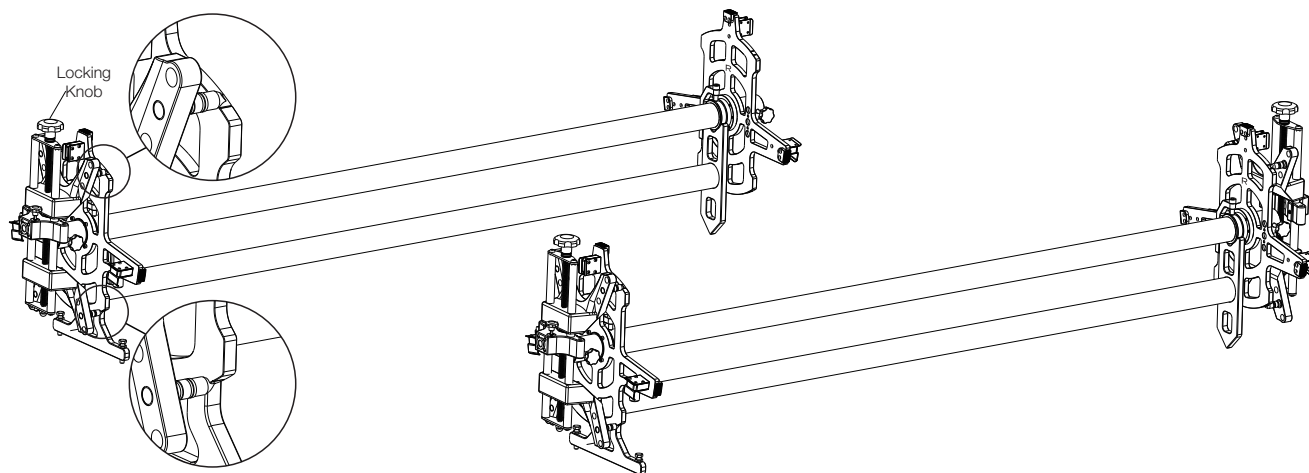

Hold the left rim clamp and face the left calibration bar mount. Grasp the rim clamp with one hand and loosen the locking knob with the other hand to place the four pawls on the rim clamp in the four limiting positions marked on the calibration bar mount. Tighten the locking knob to secure the rim clamp. The left rim clamp is now installed.

Hold the right rim clamp and face the right calibration bar mount. Install the right rim clamp in the same fashion.

NOTE: The illustrations in this Quick Reference Guide are for reference only. The actual products may differ.